

# MONTECARLO

*Home Office*



ITALIA 

---

MONTECARLO

*Home office*





*The “Montecarlo Home Office” enriches and completes the “Montecarlo” Collection.*





*High quality office furniture, beautiful and functional pieces developed and produced with close attention to all details.*

---







*“Montecarlo Home Office” offers various composition possibilities to create an environment functional to your activities and needs.*







# MONTECARLO HOME OFFICE IN KOTÒ HIGH GLOSS



**CREDENZA HUTCH W. 180 PJMN0750**  
With doors and wireway

inch W 71" D 15" H 54"  
cm L 179,6 P 38,8 H 137  
Crts 4 kg 99 m<sup>3</sup> 0,37



**FILE CABINET HUTCH W. 90 PJMN0740**  
With doors and wireway

inch W 35" D 15" H 54"  
cm L 90 P 37,6 H 137  
Crts 2 kg 46 m<sup>3</sup> 0,15



**LIBRARY BOOKCASE PJMN0770**  
(RIGHT or LEFT) With doors and shelves

inch W 39" D 15" H 84"  
cm L 100 P 38,8 H 213,4  
Crts 3 kg 100 m<sup>3</sup> 0,39

## ADDITIONAL SHELF KJMN773

inch W 18" D 13" H 1"  
cm L 46 P 33,5 H 2,5  
Crts 1 kg 6 m<sup>3</sup> 0,42

## LIGHT SYSTEM KJMN775

For Credenza hutch and File cabinet hutch

inch W 32" D 4" H 4"  
cm L 80 P 10 H 10  
Crts 1 kg 2 m<sup>3</sup> 0,67



**CREDENZA W. 180 KJMN700**  
With 2 doors and 2 large file drawers  
featuring adjustable feet levellers

inch W 71" D 21" H 30"  
cm L 179,6 P 52,7 H 76,5  
Crts 1 kg 115 m<sup>3</sup> 0,89



**FILE CABINET W. 90 RIGHT KJMN710  
LEFT KJMN715**

With 2 large file drawers  
featuring adjustable feet levellers

inch W 36" D 21" H 30"  
cm L 89,8 P 52,7 H 76,5  
Crts 1 kg 70 m<sup>3</sup> 0,46



**PEDESTAL WITH WHEELS KJMN720**  
With 1 drawer and 1 big file drawer

inch W 18" D 18" H 24"  
cm L 46,7 P 46,2 H 60  
Crts 1 kg 30 m<sup>3</sup> 0,18



**PEDESTAL WITH FEET KJMN725**  
With 1 drawer and 1 big file drawer  
featuring adjustable feet levellers

inch W 18" D 18" H 23"  
cm L 46,7 P 46,2 H 57,8  
Crts 1 kg 28 m<sup>3</sup> 0,18



**DESK W. 180 PJMN0780**

With 2 wireways  
featuring adjustable feet levellers

inch W 71" D 34" H 30"  
cm L 180 P 86 H 76  
Crts 2 kg 85 m<sup>3</sup> 0,25



**DESK W. 167 KJMN781**

With 2 wireways  
featuring adjustable feet levellers

inch W 66" D 30" H 30"  
cm L 167,5 P 76 H 76  
Crts 1 kg 77 m<sup>3</sup> 0,2



**DESK W. 120 KJMN783**

featuring adjustable feet levellers

inch W 47" D 22" H 30"  
cm L 120 P 55 H 76  
Crts 1 kg 48 m<sup>3</sup> 0,143



**RETURN DESK W. 120 KJMN784**

featuring adjustable feet levellers

inch W 47" D 22" H 30"  
cm L 120 P 55 H 76  
Crts 1 kg 42 m<sup>3</sup> 0,143



**1 FLO' CHAIR FLO\*\*\***

With chromed structure,  
seat and back in black or white leatherette

inch W 23" D 21" H 34"  
cm L 58 P 54 H 85,5  
Crts 1 kg 15 m<sup>3</sup> 0,160

**ATTENTION FOR W. 180/71" DESK:**  
When ordering the desk drawer / keyboard holder only (without the 2 lateral front panels) the drawer can be positioned centrally or laterally (to the left or to the right).

**ATTENTION FOR W. 167/66" DESK:**  
The desk drawer / keyboard holder can be positioned centrally or laterally (to the left or to the right).

**ATTENTION FOR W. 120/48" DESK / RETURN DESK:**  
The desk drawer can only be positioned centrally.



**COMPLETE DESK DRAWER /  
KEYBOARD HOLDER KJMN789**  
with 2 lateral panels (only for desk W. 180/71")

inch W 67" D 17" H 3"  
cm L 171 P 42,1 H 7,5  
Crts 1 kg 6 m<sup>3</sup> 0,04



**CENTRAL DESK DRAWER /  
KEYBOARD HOLDER KJMN788**

inch W 26" D 17" H 3"  
cm L 67 P 42 H 7,5  
Crts 1 kg 5 m<sup>3</sup> 0,04

# COMPOSITION EXAMPLES:

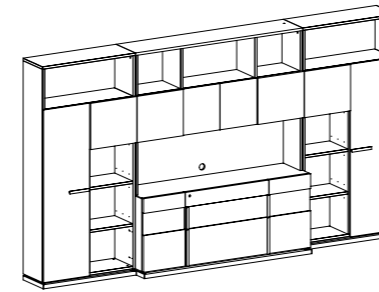

**LIBRARY COMPOSITION 1 PJMN0800**  
inch W 150" D 21" H 84"  
cm L 379,6 P 52,7 H 213,4  
Crts 11 kg 414 m<sup>3</sup> 2,048

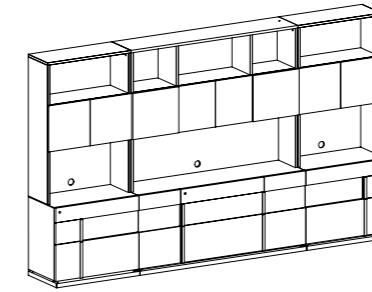

**LIBRARY COMPOSITION 2 PJMN0801**  
inch W 142" D 21" H 84"  
cm L 359,6 P 52,7 H 213,4  
Crts 11 kg 446 m<sup>3</sup> 2,482

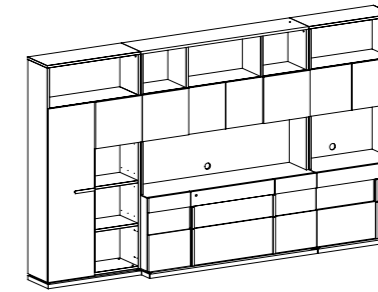

**LIBRARY COMPOSITION 3 PJMN0802**  
inch W 146" D 21" H 84"  
cm L 369,6 P 52,7 H 213,4  
Crts 11 kg 430 m<sup>3</sup> 2,265

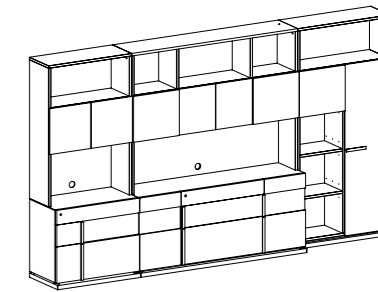

**LIBRARY COMPOSITION 4 PJMN0803**  
inch W 146" D 21" H 84"  
cm L 369,6 P 52,7 H 213,4  
Crts 11 kg 430 m<sup>3</sup> 2,265

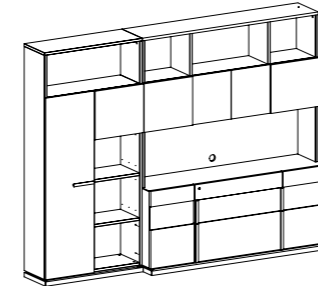

**LIBRARY COMPOSITION 5 PJMN0804**  
inch W 110" D 21" H 84"  
cm L 279,6 P 52,7 H 213,4  
Crts 8 kg 314 m<sup>3</sup> 1,655

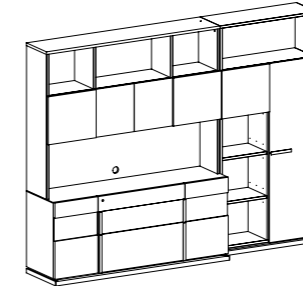

**LIBRARY COMPOSITION 6 PJMN0805**  
inch W 110" D 21" H 84"  
cm L 279,6 P 52,7 H 213,4  
Crts 8 kg 314 m<sup>3</sup> 1,655

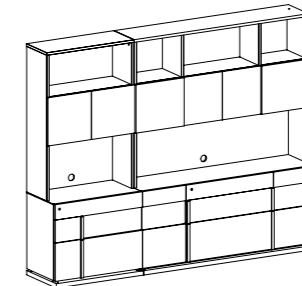

**LIBRARY COMPOSITION 7 PJMN0806**  
inch W 106" D 21" H 84"  
cm L 269,6 P 52,7 H 213,4  
Crts 8 kg 330 m<sup>3</sup> 1,872

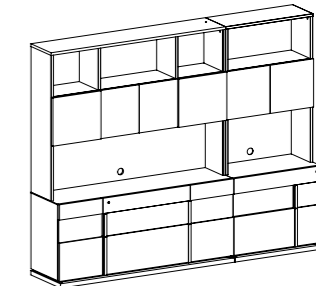

**LIBRARY COMPOSITION 8 PJMN0807**  
inch W 106" D 21" H 84"  
cm L 269,6 P 52,7 H 213,4  
Crts 8 kg 330 m<sup>3</sup> 1,872

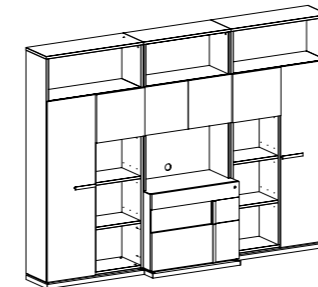

**LIBRARY COMPOSITION 9 PJMN0808**  
inch W 114" D 21" H 84"  
cm L 290 P 52,7 H 213,4  
Crts 9 kg 316 m<sup>3</sup> 1,396

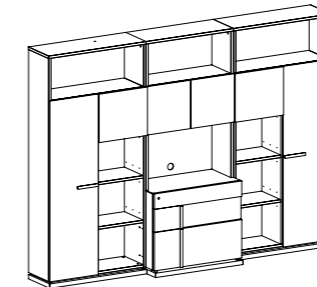

**LIBRARY COMPOSITION 10 PJMN0809**  
inch W 114" D 21" H 84"  
cm L 290 P 52,7 H 213,4  
Crts 9 kg 316 m<sup>3</sup> 1,396

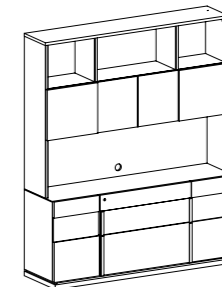

**LIBRARY COMPOSITION 11 PJMN0810**  
inch W 71" D 21" H 84"  
cm L 179,6 P 52,7 H 213,4  
Crts 5 kg 214 m<sup>3</sup> 1,262

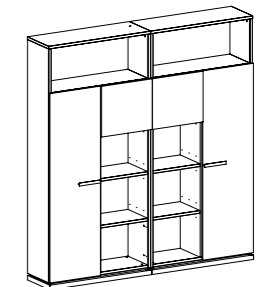

**LIBRARY COMPOSITION 12 PJMN0811**  
inch W 79" D 21" H 84"  
cm L 200 P 38,8 H 213,4  
Crts 6 kg 200 m<sup>3</sup> 0,786

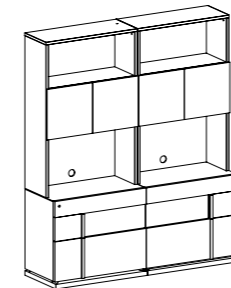

**LIBRARY COMPOSITION 13 PJMN0812**  
inch W 71" D 21" H 84"  
cm L 180 P 52,7 H 213,4  
Crts 6 kg 232 m<sup>3</sup> 1,22

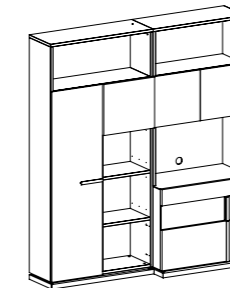

**LIBRARY COMPOSITION 14 PJMN0813**  
inch W 75" D 21" H 84"  
cm L 190 P 52,7 H 213,4  
Crts 6 kg 216 m<sup>3</sup> 1,003

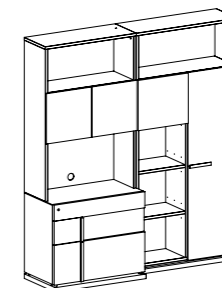

**LIBRARY COMPOSITION 15 PJMN0814**  
inch W 75" D 21" H 84"  
cm L 190 P 52,7 H 213,4  
Crts 6 kg 216 m<sup>3</sup> 1,003

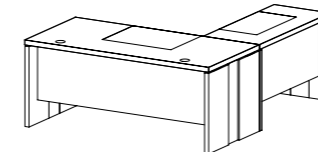

**DESK COMPOSITION 1 PJMN0816**  
Desk + Return desk  
inch W 71" D 81" H 30"  
cm L 180 P 206 H 76  
Crts 3 kg 127 m<sup>3</sup> 0,393

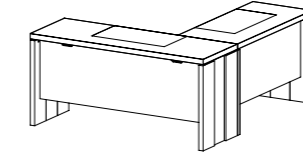

**DESK COMPOSITION 2 PJMN0817**  
Desk + Return desk  
inch W 66" D 71" H 30"  
cm L 167,5 P 175 H 76  
Crts 2 kg 94 m<sup>3</sup> 0,285

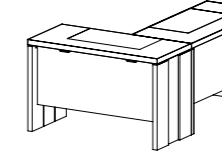

**DESK COMPOSITION 3 PJMN0818**  
Desk + Return desk  
inch W 47" D 71" H 30"  
cm L 120 P 175 H 76  
Crts 2 kg 90 m<sup>3</sup> 0,286



A.L.F. UNO S.P.A. is certified by the **ISO 9001:2008**.

Our furniture finishes are mainly UV-based. All our furniture board is within the E1 norm for formaldehyde emission. By using UV-based finish the formaldehyde is sealed within the furniture board keeping emissions to an absolute minimum.

ATTENTION: PRODUCT APPEARANCE, SIZE, AND/OR MATERIALS MAY BE SUBJECT TO CHANGE WITHOUT NOTICE

**MONTECARLO**  
Home Office

design  
c.r.s. Alf

photo  
STEP

selection  
Fotolito Maistri

print  
OGM

**CANADA & USA NORTH-EAST COAST**  
TEL. (416) 663-2223 - FAX (416) 663-2594  
E-MAIL: alf@rosnerinternational.com

**CENTRAL AMERICA - CARIBBEAN ISLANDS**  
TEL. (787) 786-9705 - FAX (787) 785-9835  
E-MAIL: alvin@arodz.net

**LOUISIANA-OKLAHOMA-TEXAS**  
TEL. (405) 204-4737  
E-MAIL: parke9094@att.net

**COLORADO-NEW MEXICO-UTAH**  
E-MAIL: alf@alf.it

**FLORIDA**  
TEL. (561) 212-5676 - FAX (561) 997-9169  
E-MAIL: hollister@bellsouth.net

**MID-WEST/SOUTH-EAST (EXCLUDING FLORIDA)**  
TEL. (310) 636-1199 - FAX (310) 636-4433  
E-MAIL: rrw@whitehalldesigns.com

**U.S.A.: HIGH POINT SHOWROOM**  
(OPEN ONLY DURING FURNITURE MARKET DATES)  
TEL. (336) 889-9027 - FAX (336) 889-9079

**WESTERN U.S.A.-HAWAII**  
TEL. (949) 374-2900 - FAX (949) 364-3822  
E-MAIL: alfwesternusa@aol.com

**AUSTRALIA & NEW ZEALAND**  
TEL. (08) 9314 3999 - FAX (08) 9314 3777  
E-MAIL: ross@merlino.com.au

**MEXICO**  
TEL. +39 3401596793 - FAX +39 0438997246  
E-MAIL: giulio.botteon@italfurniture.it

**AUSTRIA**  
E-MAIL: alf@alf.it

**GERMANY**  
TEL. 0049 2536343450 - FAX 0049 2536343456  
E-MAIL: info@magenta-vertrieb.de

**SWITZERLAND**  
TEL. 0041 523661277  
TEL. 0041 764174344 E-MAIL: marcopetix@gmx.ch  
TEL. 0041 794048941 E-MAIL: spetix@gmx.ch

**DENMARK**  
TEL. +45 20475875  
E-MAIL: lehr@mail.dk

**EAST EUROPE**  
TEL. +39 3484064921  
E-MAIL: caputomauro@libero.it  
HUNGARY: johns@johns.hu  
CZECH-SLOVACK: infinity.prague@volny.cz

**U.K.**  
TEL. +44 1565631077 - FAX +44 1565621436  
E-MAIL: tim@3dpartnership.com  
andrew@3dpartnership.com - jt@3dpartnership.com

**FRANCE - BRETAGNE - NORMANDIE - CENTRE**  
TEL. 0033608423974  
E-MAIL: contact@jmcsarl.fr

**FRANCE - EST**  
TEL. 0033615436985  
E-MAIL: ch.vidrin@wanadoo.fr

**FRANCE - SUD-EST**  
TEL. 33651330596 - FAX 33958730003  
E-MAIL: albouy@sanitairediffsion.fr

**FRANCE - ILE DE FRANCE**  
TEL. 0033609810991  
E-MAIL: catherinepouette@wanadoo.fr

**FRANCE - NORD**  
TEL. 0033660816585  
E-MAIL: treuil.pa@wanadoo.fr

**FRANCE - SUD-OUEST**  
TEL. 0033668088876 - FAX 0033553289387  
E-MAIL: fabien.lherbette@hotmail.fr

**FRANCE - RHONE/ALPES**  
TEL. 0033689923725 - FAX 0033466777294  
E-MAIL: fredericc.ac@orange.fr

**HELLAS-CYPRUS**  
TEL. +39 0434 77199 - FAX +39 0434 779591  
E-MAIL: info@cfsolution.it

**INDIA-SRI LANKA**  
TEL. +91 8041285290 - 91 9845636644  
E-MAIL: keith@kreb.in

**ALF GROUP MIDDLE-EAST REP. OFFICE**  
TEL. +961 4718160 - FAX +961 4718159  
E-MAIL: info@alfme.com

**POLAND**  
TEL. +48 618175994 - FAX +48 616429218  
E-MAIL: karina@qualitaitaliana.pl

**CSI E PAESI BALTICI**  
TEL. +7-812-3322934 - FAX +7-812-3322934  
E-MAIL: office.spb@alf.it

**SOUTH AFRICA**  
TEL. +27 823225215 - FAX +27 865018307  
E-MAIL: clint@furntec.co.za

**SPAIN - ANDALUCIA Y EXTREMADURA**  
TEL. +34 958818744 - FAX +34 958302251  
E-MAIL: info@javiercastellon.com

**SPAIN - ASTURIAS Y CANTABRIA**  
TEL. +34 609 803 348 - FAX +34 985 894 580  
E-MAIL: geliqintueles@yahoo.es

**SPAIN - CASTILLA Y LEON**  
TEL. +34983541003 - FAX +34983541003  
E-MAIL: evaristorg@gmail.com

**SPAIN - BARCELONA - CATALUNYA Y ANDORRA**  
TEL. +34 935531590 - FAX +34 935531590  
E-MAIL: albert-miro-mauri@hotmail.com

**SPAIN - VALENCIA, MURCIA Y CASTILLA LA MANCHA**  
TEL. +34 607 210 185  
E-MAIL: joseluis@nexus-jlh.com

**SPAIN - ARAGÓN, SORIA, LA RIOJA, NAVARRA Y PAIS VASCO**  
MALLORCA, MENORCA, IBIZA, FORMENTERA  
E-MAIL: alf@alf.it

**TURKEY**  
TEL. +90 3128475080 - FAX +90 3128475280  
E-MAIL: casa@casa.com.tr



**A.L.F. UNO S.P.A.**

VIA S. PIO X, 17 31018 FRANZENIGO DI GAIARINE (TV) ITALY

TEL. +39-0438 997 111 FAX +39-0438 997 246

alf@alf.it www.alfitalia.com